

93 Waterside Mews, Cyril Bell Close, Lymm WA13 0JU

£265,000

🛏 2 🚿 1 🚗 1



AN EARLY VIEWING IS STRONGLY RECOMMENDED TO APPRECIATE THIS GROUND FLOOR TWO BEDROOM RETIREMENT APARTMENT WITH DELIGHTFUL VIEWS OVER THE BRIDGEWATER CANAL.

Key Features

- Ground floor two bed retirement apartment
- NO CHAIN
- On-site Laundry in close proximity to the apartment
- Well maintained interior
- Parking close to the apartment with visitors spaces
- Views over the Bridgewater Canal
- Established retirement community with 24 hr Warden and Care Alarm system
- Sought after prime location
- Manicured communal gardens
- Early internal viewing highly recommended

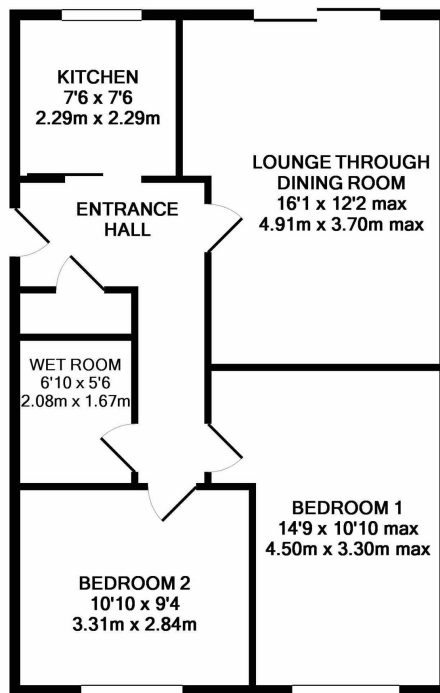

TOTAL APPROX. FLOOR AREA 607 SQ.FT. (56.4 SQ.M.)

Whilst every attempt has been made to ensure the accuracy of the floor plan contained here, measurements of doors, windows, rooms and any other items are approximate and no responsibility is taken for any error, omission, or mis-statement. This plan is for illustrative purposes only and should be used as such by any prospective purchaser. The services, systems and appliances shown have not been tested and no guarantee as to their operability or efficiency can be given.
Made with Metropix ©2018